



SHELTER STRUCTURES

PRODUCT SPECIFICATIONS

SHELTER A-FRAME L-SERIES

TENT SPECIFICATIONS

Model	L30
Span Width	30m
Eave Height	4.00m
Ridge Height	9.00m
Bay Distance	5m
Roof Pitch	18°
Longest Component	10.62m
Maximum Length	Unlimited in 5-meter increments
Max. WindLoad	120km/h (0.60kN/m ²)

FRAMEWORK

Main Profiles	120*300*5mm (4 channel)
Material	Hard Pressed Extruded Structural Aluminum 6061/T6

COVER

Material	PVC Coated Polyester Fabric
Features	650 or 850 g/sqm, Premium Grade, High Gloss White or Translucent, Waterproof, UV Resistant
Flame Retardant	DIN 4102 B1, M2; USA NFPA701

CONNECTING COMPONENTS

Hot Dipped, Structural Grade Corrosive Resistant Galvanized Steel

L-SERIES DRAWING

Rendering



Gable Drawing

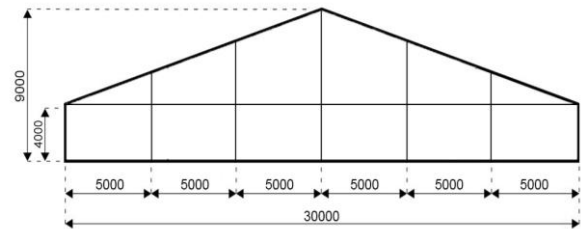

Frame Drawing

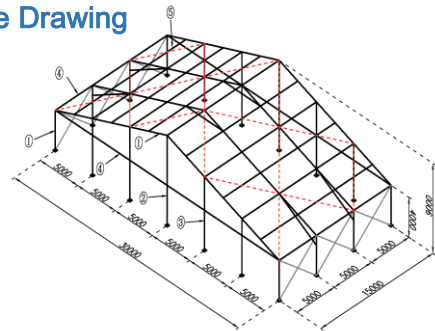

Profile Specifications

Upright Support Roof Beam ①	Gable Middle Upright ②	Gable Upright ③	Eave Purlin ④
			Roof Purlin ⑤



SHELTER STRUCTURES
TENT MANUFACTURER

Headquarter & Production

Chaotian Industrial Park, Panyu, Guangzhou, China.

E: admin@shelter-structures.com

M: +1 713-386-9281

W: www.shelter-structures.com

T: +8620 6660 3258